

Frauenkirche - Bauvorlagen - 1

Anker Steinbaukasten Nr. 26

letzte Überarbeitung: 02.2009

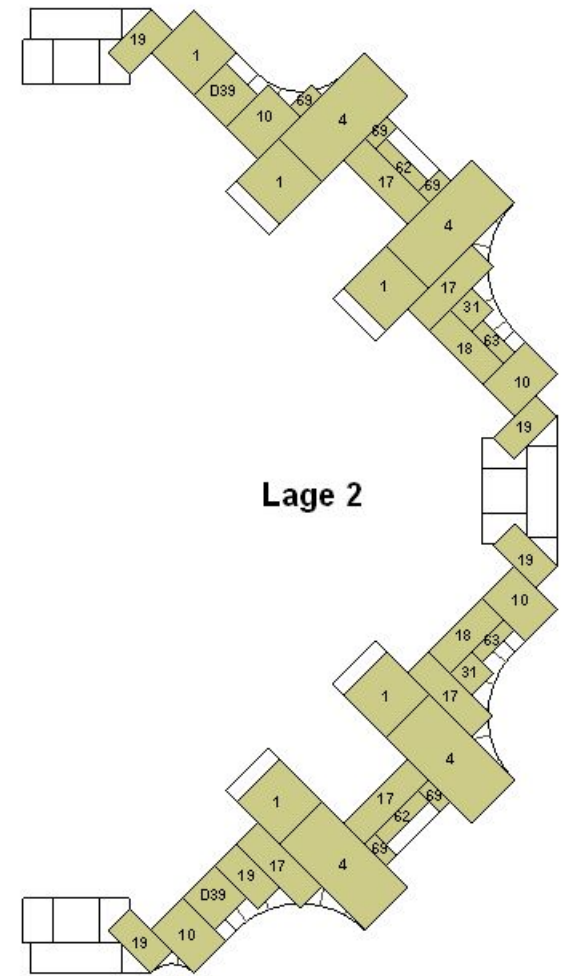
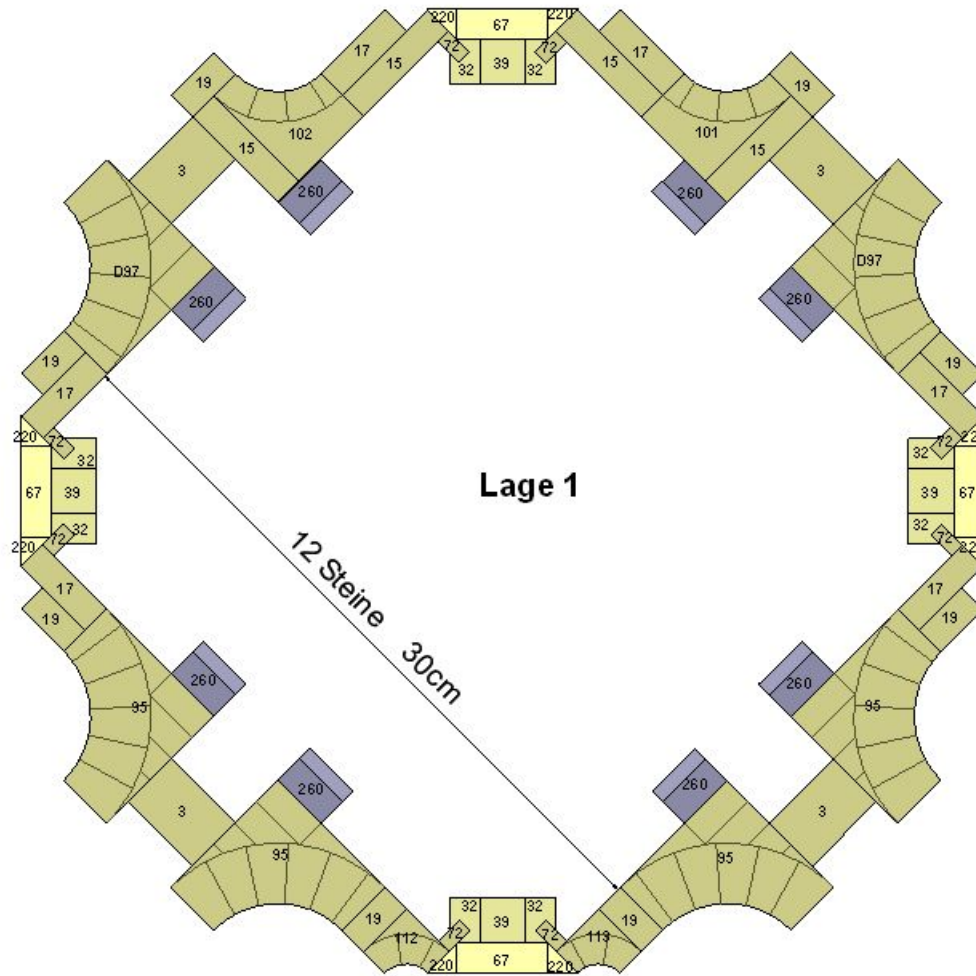

Entwurf: Falk Gundel, Dresden

Frauenkirche - Bauvorlagen - 2

Anker Steinbaukasten Nr. 26

letztes U überarbeitung: 02.2008

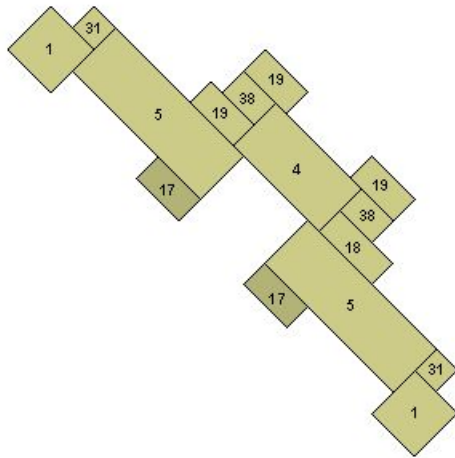

Lage 3

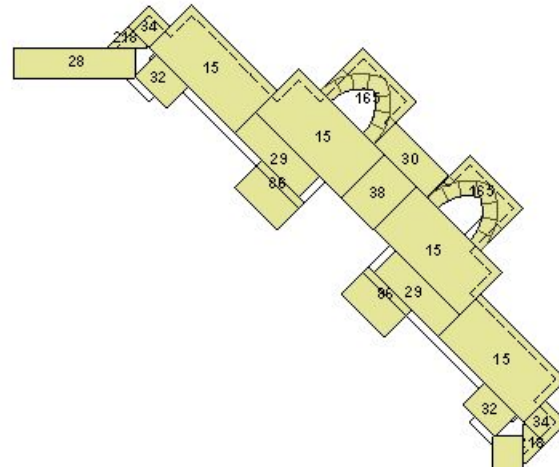
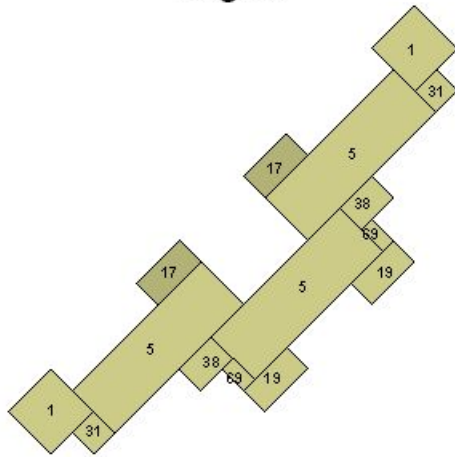

Lage 4

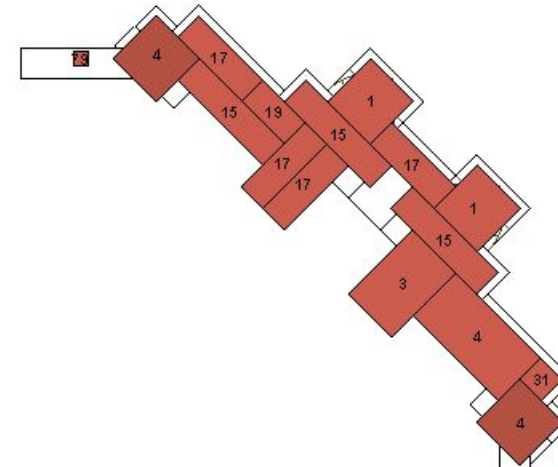

Lage 5

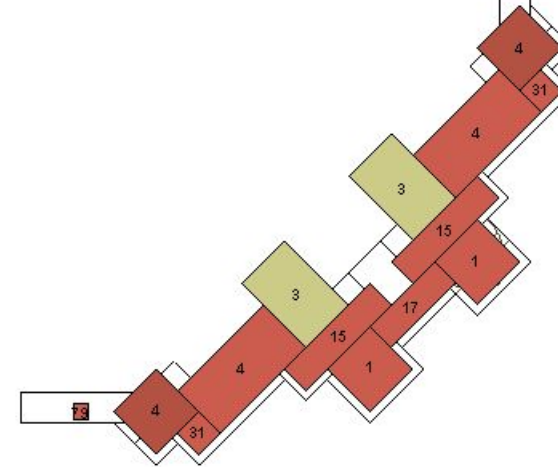

Entwurf: Falk Gundel, Dresden

Frauenkirche - Bauvorlagen - 7

Anker Steinbaukasten Nr. 26

letzte Überarbeitung: 02.2008

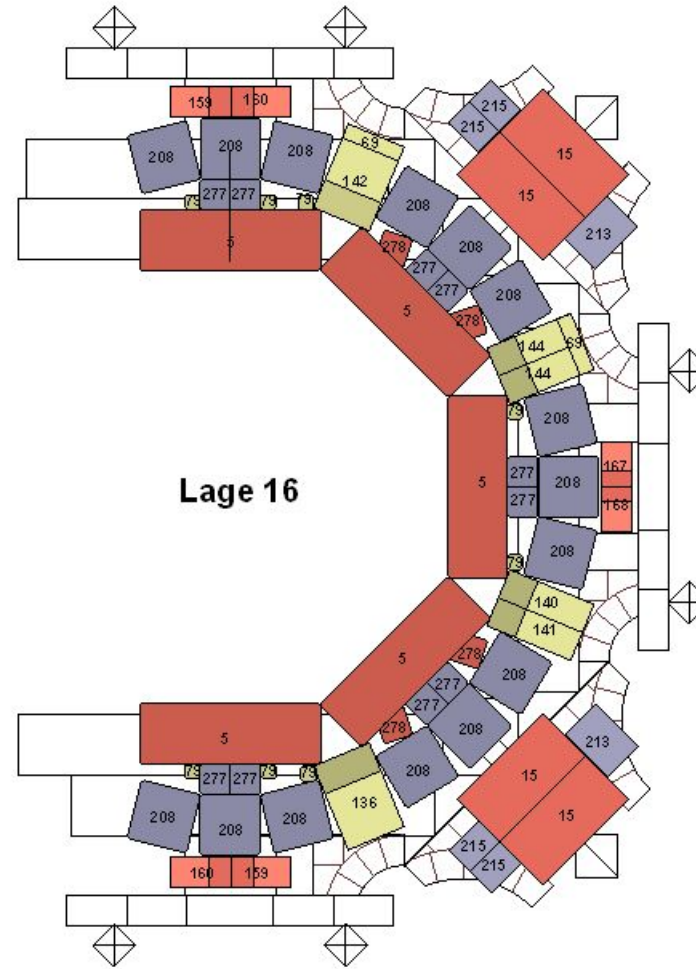
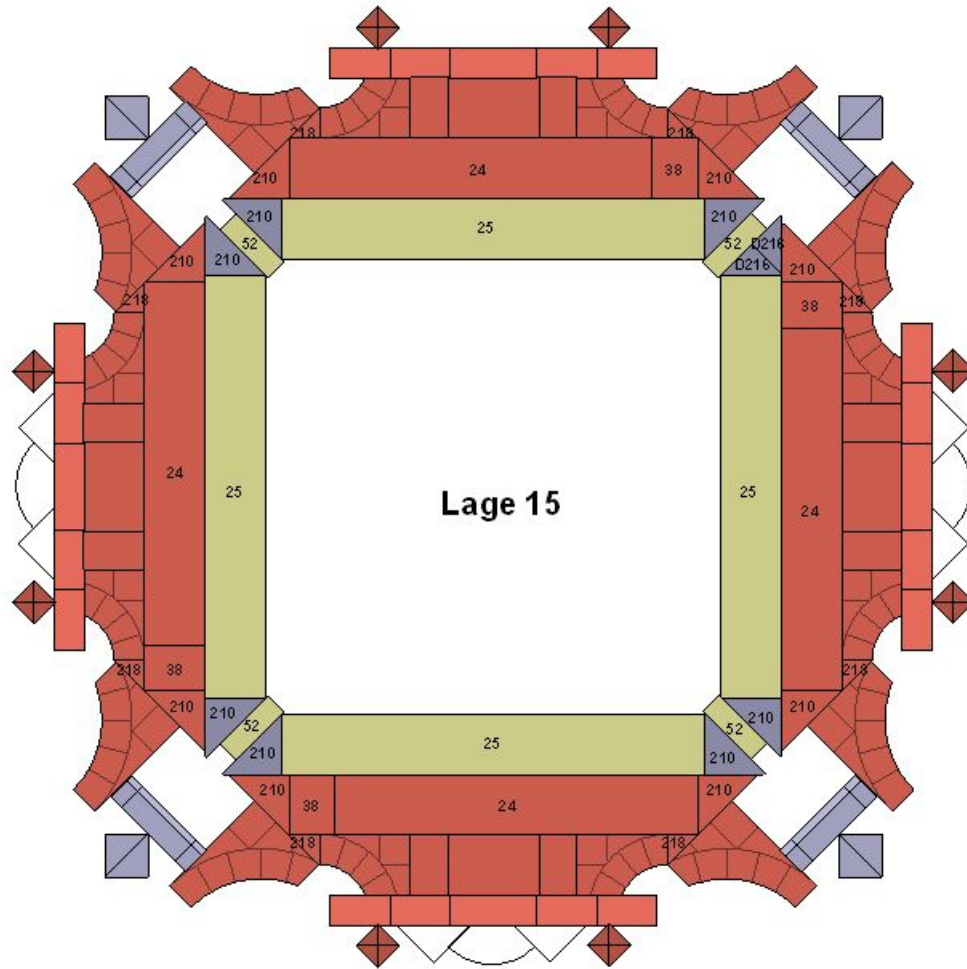

Entwurf: Falk Gundel, Dresden

Frauenkirche - Bauvorlagen - 9

Anker Steinbaukasten Nr. 26

letztes Update: 02.2009

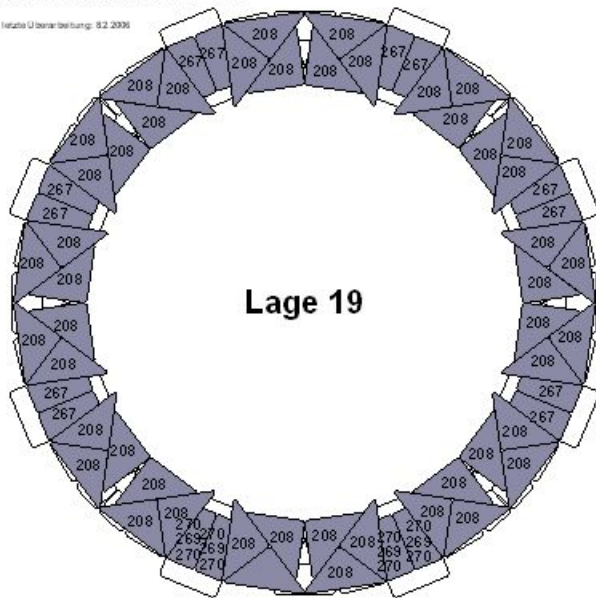

Lage 19

Entwurf: Falk Gundel, Dresden

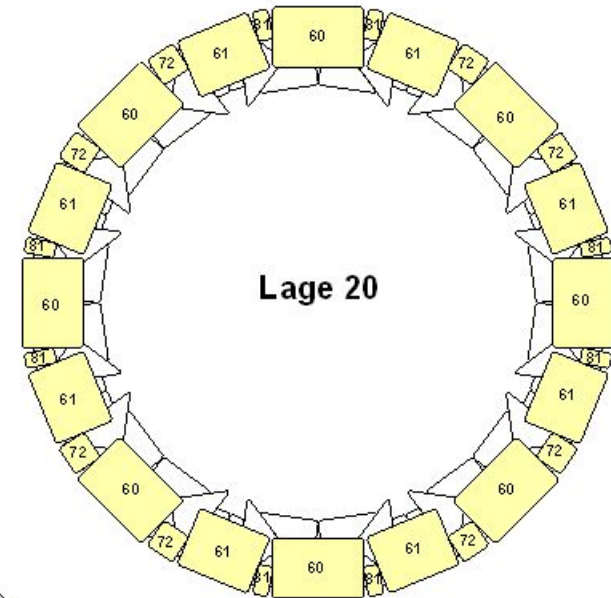

Lage 20

Entwurf: Falk Gundel, Dresden

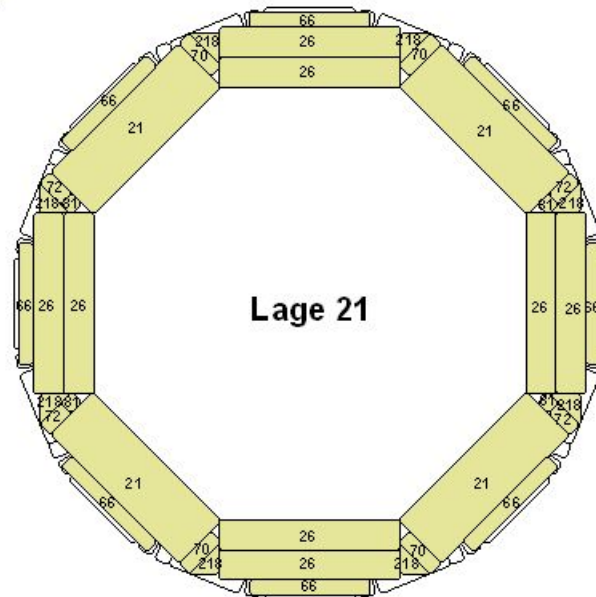

Lage 21

Frauenkirche - Bauvorlagen - 10

Anker Steinbaukasten Nr. 26

letzte Überarbeitung: 02.2006

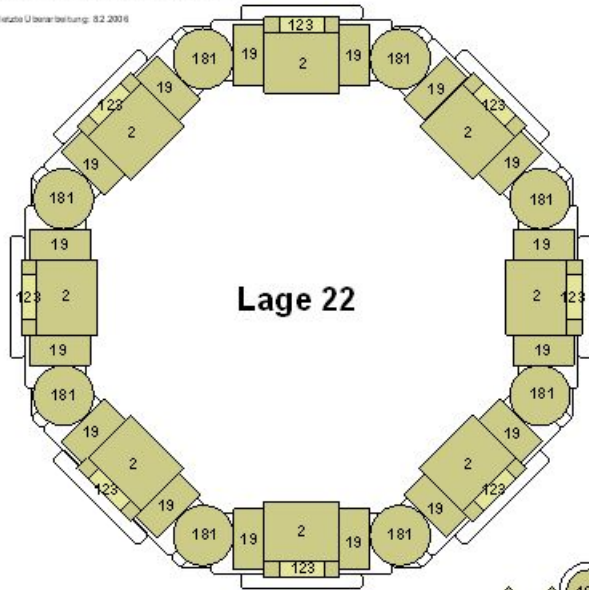

Lage 22

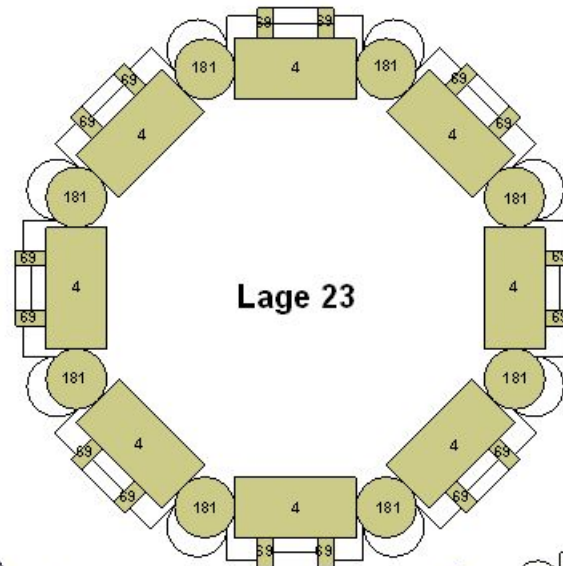

Lage 23

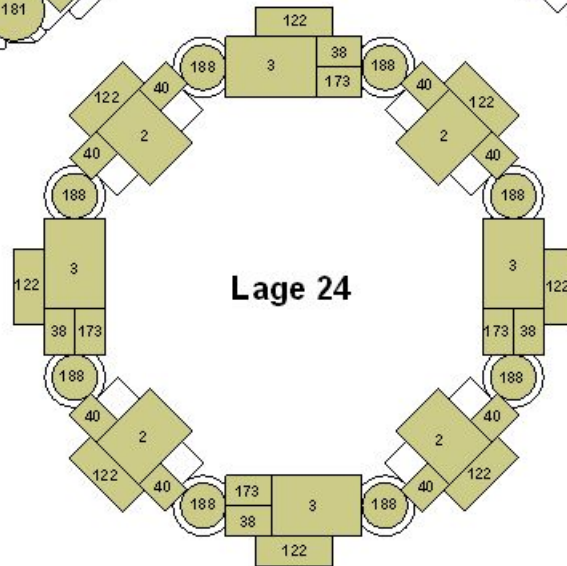

Lage 24

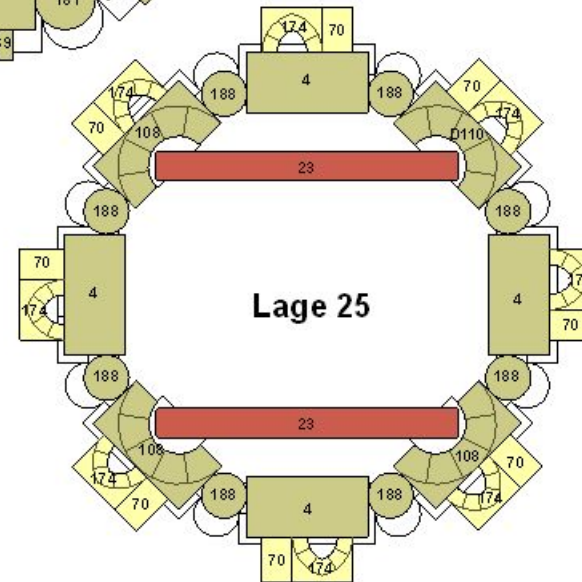

Lage 25

Entwurf: Falk Gundel, Dresden

Frauenkirche - Bauvorlagen - 12

Anker Steinbaukasten Nr. 26

letzte Überarbeitung: 02.2006

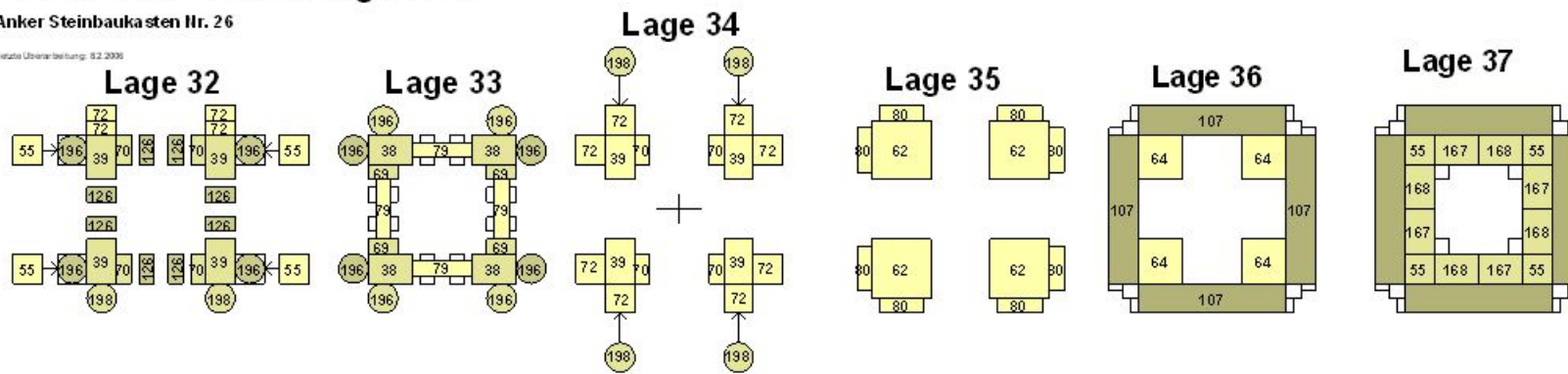

Lage 38

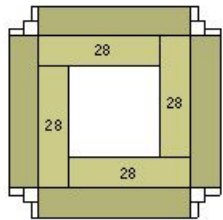

Lage 39

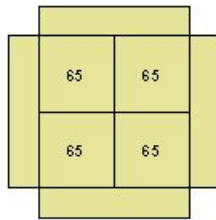

Lage 40

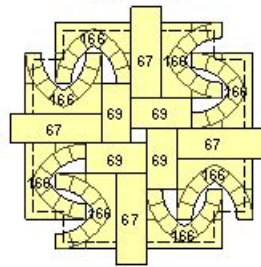

Lage 41



Lage 42

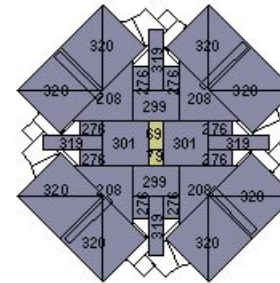

Lage 43

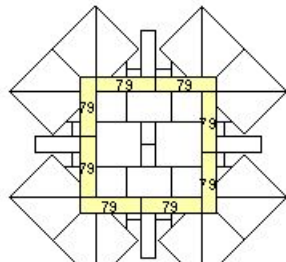

Lage 44

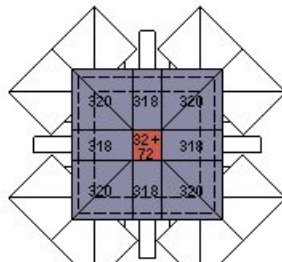

Lage 45



Lage 46

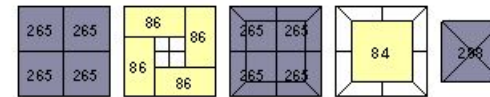
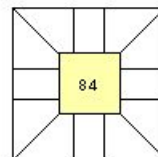

unter Lage 43 ein Stück Sandpapier 56x56 unterlegen

Entwurf: Falk Gundel, Dresden

Frauenkirche - Bauvorlagen - 13

Anker Mosaikbaukasten

letzte Überarbeitung: 8.22.09

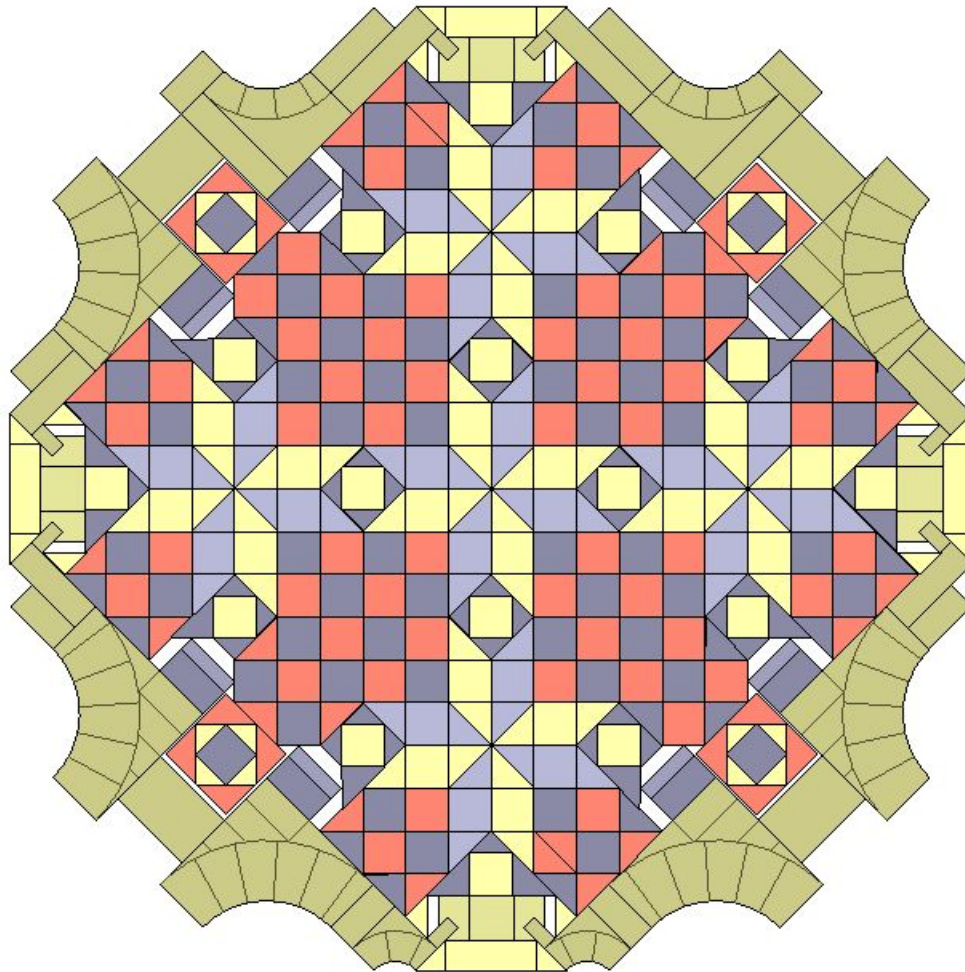

Entwurf: Falk Gundel, Dresden